

EUROPEAN WATER FITTINGS

Manufactured by European standards. Consisting of valved quick release couplings - valved and non-valved nipples, allowing fast, safe and unmessy tool changes. Couplings and nipples manufactured from brass and suitable for temperatures to 200°C. Nipples are designed to be recessed below mould surfaces.

Couplings

a) With Male Barb

CODE	d1/d4	d2	d3	PBAR	TYPE	EOC PART NO	HASCO PART NO
HCT3100 or TUK3100	9	6	17	15	Straight Coupling	MK10/9	Z80/9
HCT3105	13	9	22	10	Straight Coupling	MK10/13	Z80/13
HCT3110	9	6	17	15	45° Coupling	MK12/9	Z80/9/45
HCT3115	13	9	22	10	45° Coupling	MK12/13	Z80/13/45
HCT3120	9	6	17	15	90° Coupling	MK15/9	Z80/9/90
HCT3125	13	9	22	10	90° Coupling	MK15/13	Z80/13/90

b) With Male Thread

CODE	d4	d	d3	l	l1	PBAR	EOC PART NO	HASCO PART NO
HCT3130	9	G1/4	18	38	9	15	MK20/9	Z82/9/R1/4
HCT3135 or TUK3135	13	G3/8	23	38	9	10	MK20/13	Z82/13/R3/8

Nipples

CODE	d4	d	d2	TYPE	EOC PART NO	HASCO PART NO
HCT3200	9	G1/8	6	non-valved	ST11/9 R1/8	Z81/9/R1/8
HCT3205 or TUK3205 or RED3205	9	G1/4	6	non-valved	ST11/9 R1/4	Z81/9/R1/4
HCT3210 or TUK3210 or RED3210	13	G1/4	9	non-valved	ST11/13 R1/4	Z81/13/R1/4
HCT3215	13	G3/8	9	non-valved	ST11/13 R3/8	Z81/13/R3/8
HCT3220	9	G1/4	6	valved	ST13/9 R1/4	Z811/9/R1/4
HCT3224	13	G1/4	9	valved		
HCT3225	13	G3/8	9	valved	ST13/13 R3/8	Z811/13/R3/8

Nipple Extensions

CODE	DESCRIPTION
HCT3226	As HCT3200 above but 100mm long
HCT3227	As HCT3205 above but 100mm long
HCT3228	As HCT3210 above but 100mm long

Connectors

CODE	d1/d4	d2	l	l1	EOC PART NO	HASCO PART NO
HCT3230	9	6	40	17	ST12/9	Z83/9

TAP SETS

Maintain your moulds with these tap sets.

CODE	DESCRIPTION
TTL9990	1/8" BSPT 2 piece HSS tap set
TTL9991	1/4" BSPT 2 piece HSS tap set
TTL9992	3/8" BSPT 2 piece HSS tap set

MOULDPRO HOSES

Specifically designed for the moulding industry up to 15 bar pressure complete with cut-to-length and crimping of fittings service. 10mm & 13mm ID hose in 50M rolls, 19mm in 30M rolls.

CODE	d1 (mm)	D (mm)	SPECIFICATION	SERVICE	TEMPERATURE RATING
HCT9601	10	16.5	Blue E10B	Water	164°C
HCT9602	10	16.5	Red E10R	Water	164°C
HCT9701	10	16.5	Blue G10B	Water	100°C
HCT9702	10	16.5	Red G10R	Water	100°C
HCT9604	13	21	Blue E13B	Water	164°C
HCT9605	13	21	Red E13R	Water	164°C
HCT9704	13	21	Blue G13B	Water	100°C
HCT9705	13	21	Red G13R	Water	100°C
HCT9707	19	27	Blue G19B	Water	100°C
HCT9708	19	27	Red G19R	Water	100°C
HCT9625	13	19	Stainless Braided	Water	170°C

Note: Crimping sleeves for 16.5mm OD hose = HCT9632A, 19mm OD hose = HCT9635, 21mm OD hose = HCT9636 & 27mm OD hose HCT9639

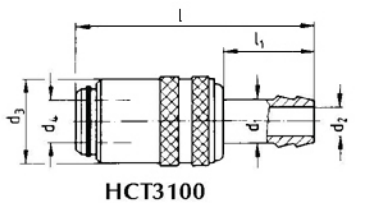

HCT3100

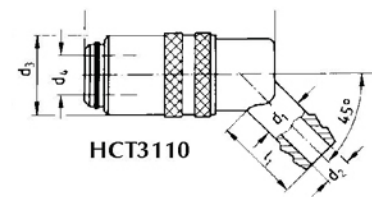

HCT3110

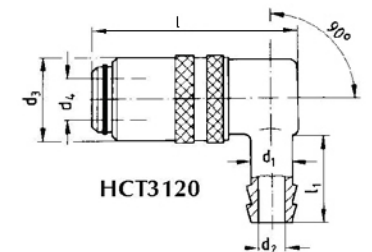

HCT3120

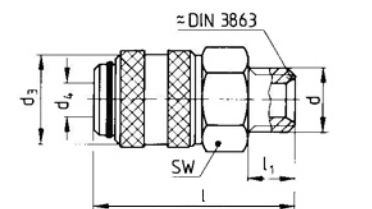

HCT3130

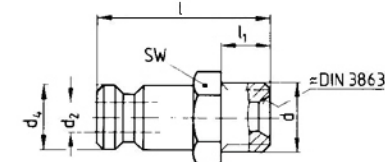

HCT3200

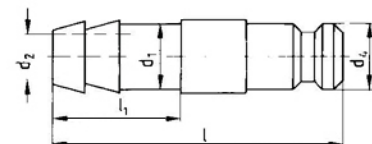

HCT3230



TTL9990

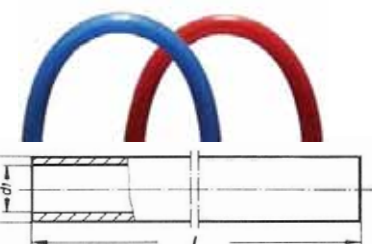

HCT9601

